

www.npad-inc.com

Essex County Turtle Back Zoo Window and Interior Renovation Project

Essex County, NJ

PROJECT NAMES:

Turtle Back Zoo Renovation Project

PROJECT OWNER/ CLIENT

Essex County
Department of Public Works
900 Bloomfield Avenue
Verona, NJ 0044

CONSTRUCTION COST

\$636,000

PROJECT SERVICES

Architectural
RFP Review
Electric
Mechanical
Planning Board Testimony
Construction Field Monitoring
Construction Administration

PROJECT DESCRIPTION

The project involves approximately 5,176 square feet of building alterations and renovations.

The existing building design resulted in a year round public use and additional exhibit space for the zoo officials to showcase their animals. The interior space reflects complete fixed metal window replacement and new heating, ventilation and air condition system (HVAC) that fosters a forest habitat. The equipment required to make the HVAC operable is encased and resembles tree branches wrapping the interior of the 3,360 sf space. In addition, the electrical fixtures such as the ceiling fans and acorn lights add more air circulation and lighting. The tile flooring is custom designed to embrace the wonderful Turtle Back Zoo logo installed in the center of the space. New thermal windows and handicap accessible doors replaced the old roll down doors with screens and entry doors. The window design blends in nicely with the existing building, enhancing the aesthetics of the space. Two new dormers were constructed at the main entrance and new rear entrance to mark the entry points into the building and to remove rain and snow from the entrances.

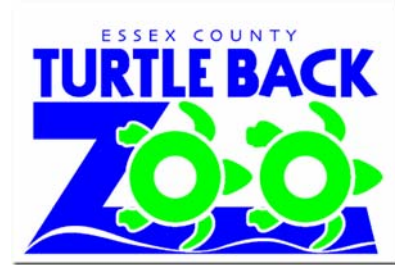

Turtle Back Logo

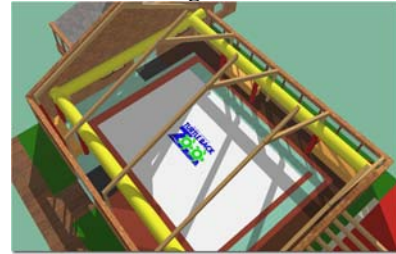

Aerial View of Interior Space



Side Entrance Design

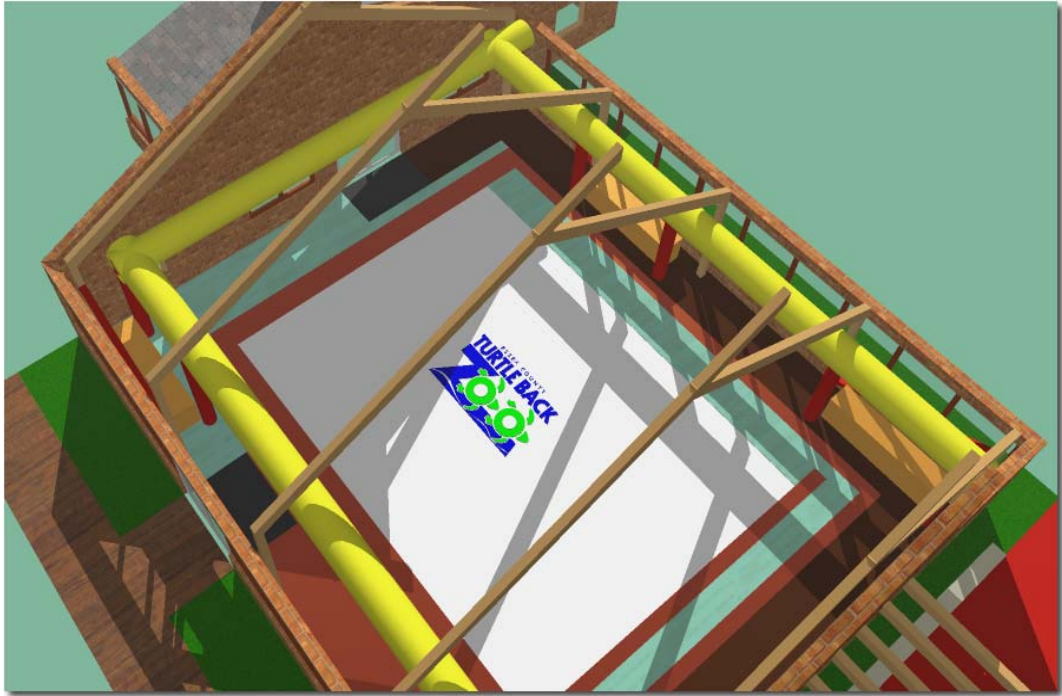

Aerial View of Interior Space



Side Entrance Design